

Circular step displacement diffuser

Description

The circular step displacement diffuser are designed to achieve reduced air velocities, sound power level and improved comfort.

The units are manufactured from sheet steel and come with a white coating (RAL 9010) or black coating (RAL 9005) as standard. The diffuser may be coated in a different colour (upon request) to adapt to the décor of the installation site.

Application

The diffusers are designed to provide air conditioning in theatres, auditoriums, cinemas, etc.

In the aforementioned locations, the diffusers are generally installed with one unit per seat, generating an individual microclimate which guarantees the necessary air ventilation for each person.

Given that the distance from the diffuser plate to the person's legs is very short, it is recommended to work with a maximum temperature difference (supply temp./room temp.) of $\pm 6^\circ\text{C}$ to avoid generating uncomfortable air currents

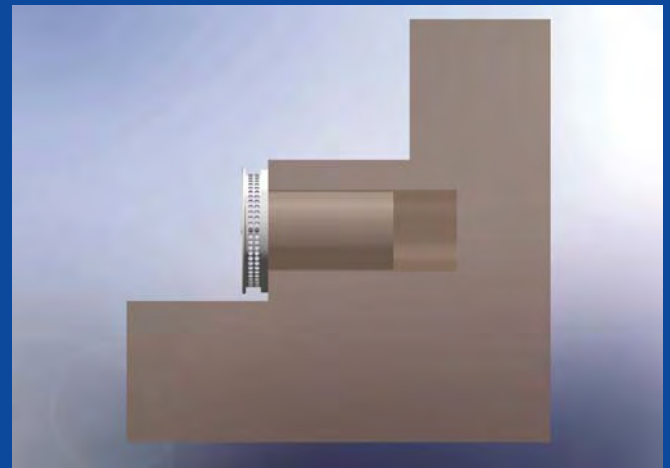
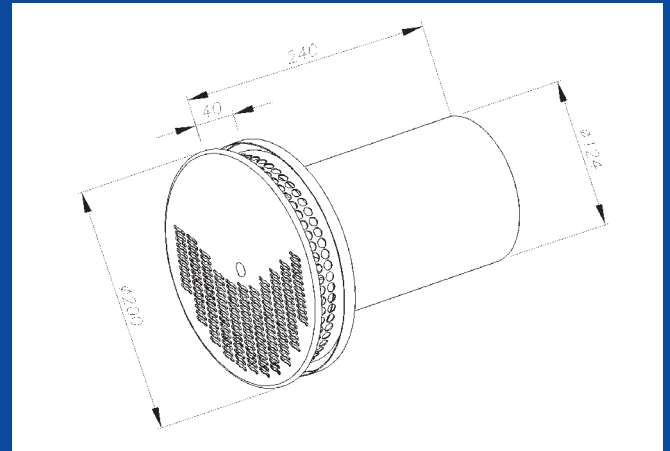

QUICK SELECTION TABLE

AIRFLOW - SOUND POWER - PRESSURE DROP					
	m ³ /h (Pa)				
	15 dB(A)	20 dB(A)	25 dB(A)	30 dB(A)	35 dB(A)
DFP-125	62 (3)	75 (4)	89 (6)	107 (8)	127 (11)